

Teifs TEK TIPS

December 2004
Category 5

Detailing Series

The issue:

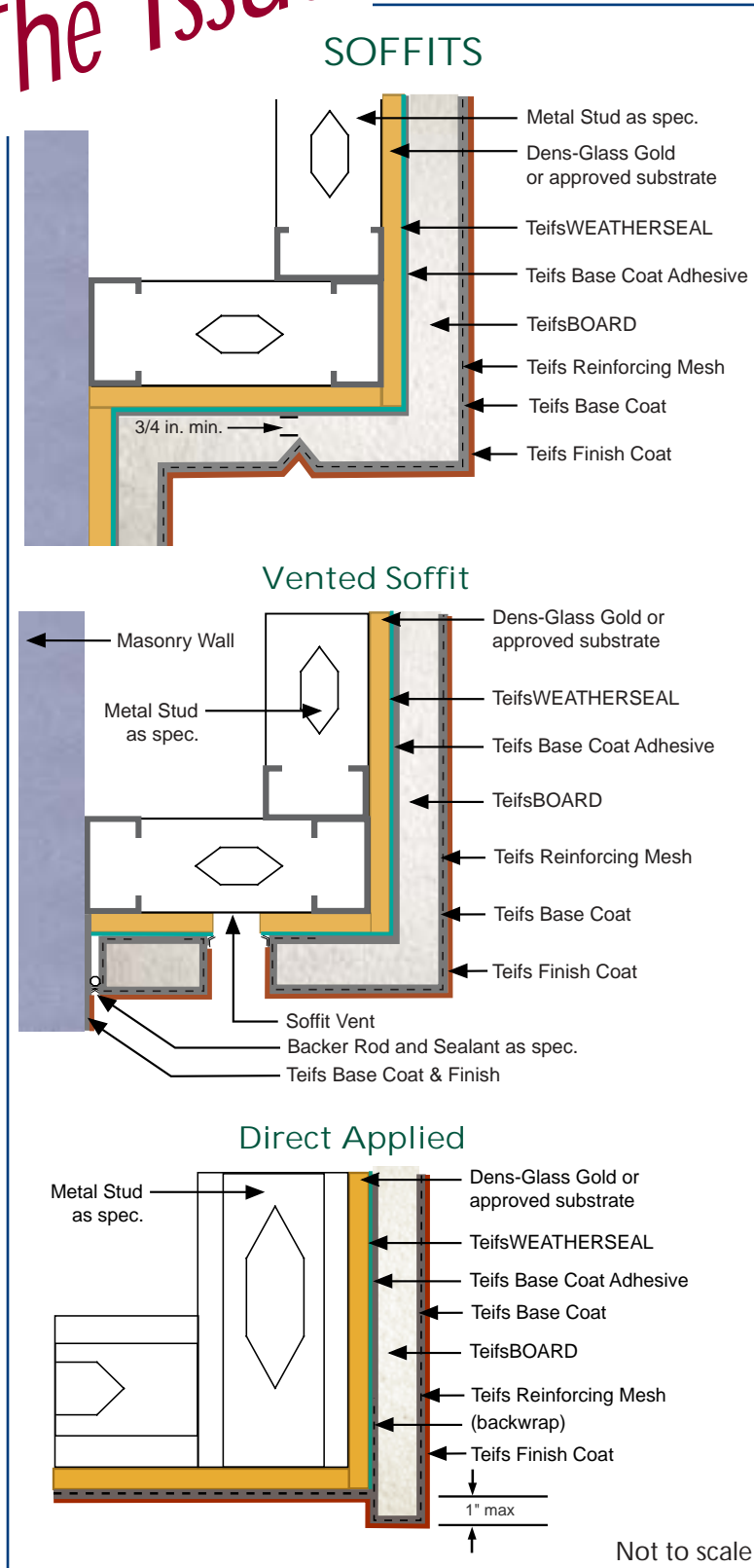

NOTES

- Insulation board should only be used on small soffit areas with a maximum of 4' in width. Large soffits or overhangs should utilize a direct applied system.
- Unheated soffit areas may require venting and will need to be detailed by the project design professional.
- Where wall/soffit are subject to differential movement, provide a joint at the inside corner.
- Some local codes may require a weather resistive barrier behind soffit board unless fascia extends 12" (300 mm) beyond soffit line.

Direct applied Soffit Systems

- Teifs Lamina can be directly applied in a soffit application to the Dens-Glass® Gold by Georgia-Pacific® Corp., Eterspan® by Eternit, Harditex® or Hardiflex® by James Hardie Building, Durock® by U. S. Gypsum Co., Exterior Gypsum Ceiling Board by U. S. Gypsum Co. Or Permabase® Sheathing By National Gypsum Co.
- Deflection of substrate systems shall not exceed L/240.
- Design minimum 1/4 inch (6 mm) wide sealant joints at penetrations through the system (lights, vents, etc.).
- Fasten surface mount accessories (for example, casing beads and surface mount expansion joints) through the sheathing into framing at locations indicated on architectural drawings. Where necessary, level surfaces such as outside corners with appropriate leveling material to maintain plumbness and squareness.

SOFFITS WITHOUT EPS INSULATION
REQUIRE EXPANSION JOINTS
EVERY 20 FT (6 M).



Teifs WEATHERTIGHT Wall System

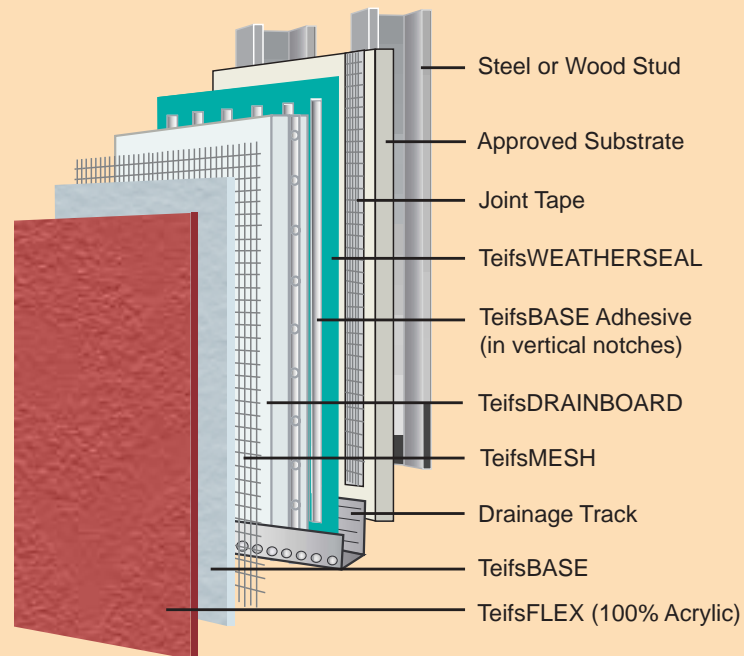

This Exterior Insulation and Finish System features multiple layers of protection against water penetration:

- ❖ *TeifsWEATHERSEAL, a special 100% acrylic air shield and waterproof protective coating*
- ❖ *TeifsDRAINBOARD, exclusively patented with vertical and horizontal drainage channels*
- ❖ *TeifsLAMINA (base coat, mesh, and finish), tested above and beyond industry standards*
- ❖ *Drainage Track*

Look for more TeifsTEK TIPS Coming Soon!



220 Burseson • San Antonio, Texas • 78202
Phone (210) 472-2935 • Fax (210) 472-2946 • 1-800-358-4785
www.teifs.com • teifs@teifs.com