

TeifsTEK TIPS

January - March 2005
Category 1

Detailing Series

The issue:

POP OUTS

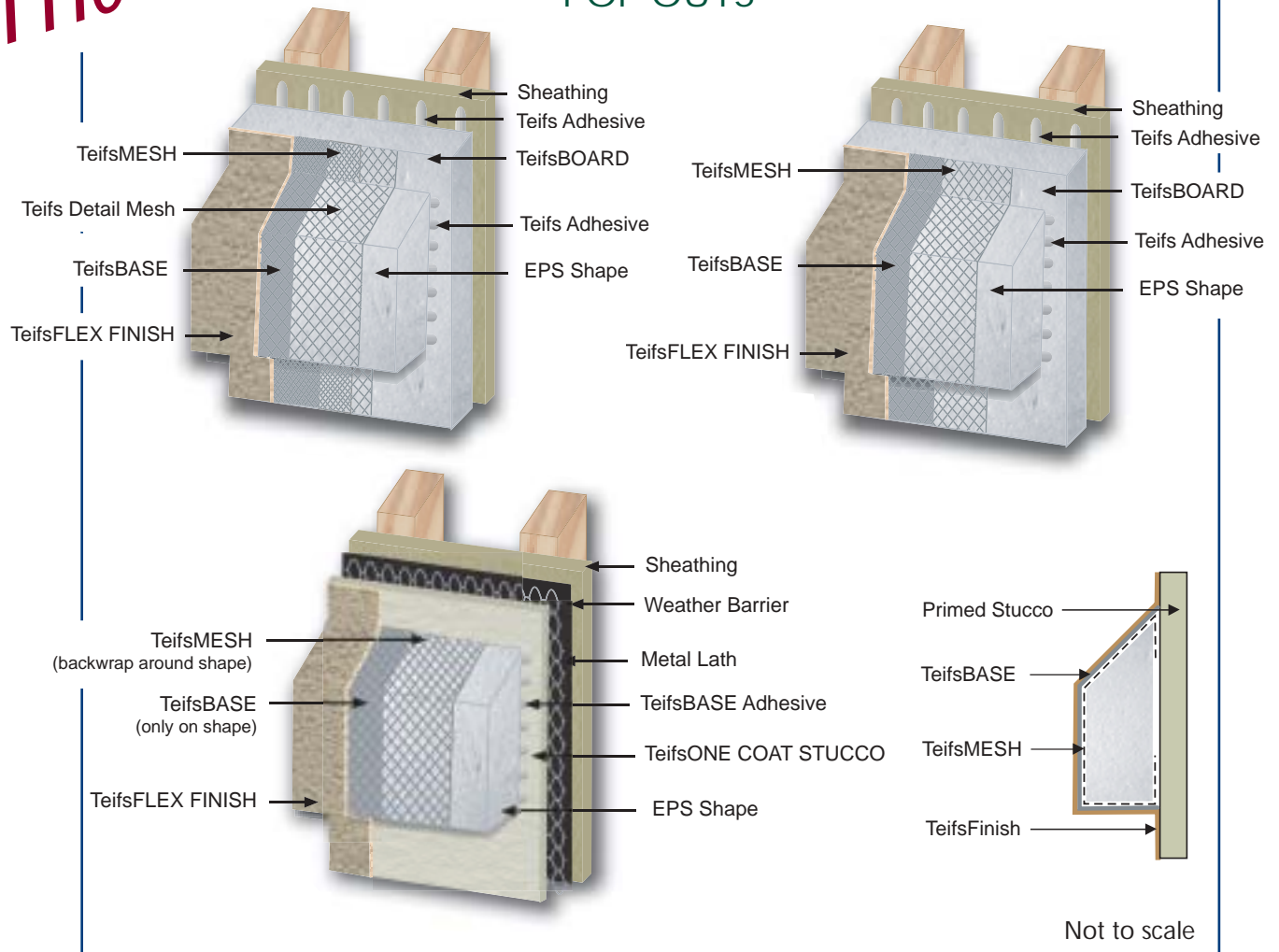

NOTES

Popouts On EIFS

- EPS must be sloped to prevent standing water.
- To protect larger horizontal surfaces, high impact mesh and TeifsSTAYDRY Base Coat should be used.
- Mesh must be overlapped a minimum of 2-1/2 inches.
- When using Detail mesh, overlap TeifsMESH a minimum of 2-1/2 inches.

EPS Shape over Stucco

- TeifsPRIME should be applied over the TeifsBase and Stucco before application of the Finish Coat to give a more consistent color.
- For a more consistent color and texture, TeifsBase can be applied over the entire stucco surface before application of the Teifs Finish Coat.



Teifs WEATHERTIGHT Wall System

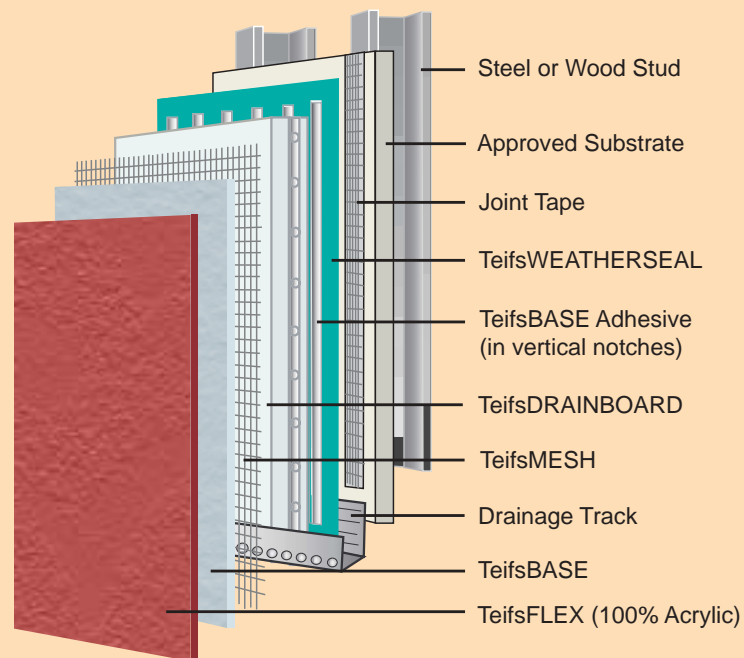

This Exterior Insulation and Finish System features multiple layers of protection against water penetration:

- ❖ *TeifsWEATHERSEAL, a special 100% acrylic air shield and waterproof protective coating*
- ❖ *TeifsDRAINBOARD, exclusively patented with vertical and horizontal drainage channels*
- ❖ *TeifsLAMINA (base coat, mesh, and finish), tested above and beyond industry standards*
- ❖ *Drainage Track*

TeifsTEK TIPS is now published quarterly.



220 Burseson • San Antonio, Texas • 78202
Phone (210) 472-2935 • Fax (210) 472-2946 • 1-800-358-4785
www.teifs.com • teifs@teifs.com