

# Teifs TEK TIPS

March 2004  
Category 3

## Detailing Series

*The issue:*

The EIF System needs to be properly protected and installed at grade in order to prevent water from wicking up and/or insects from entering the wall system.

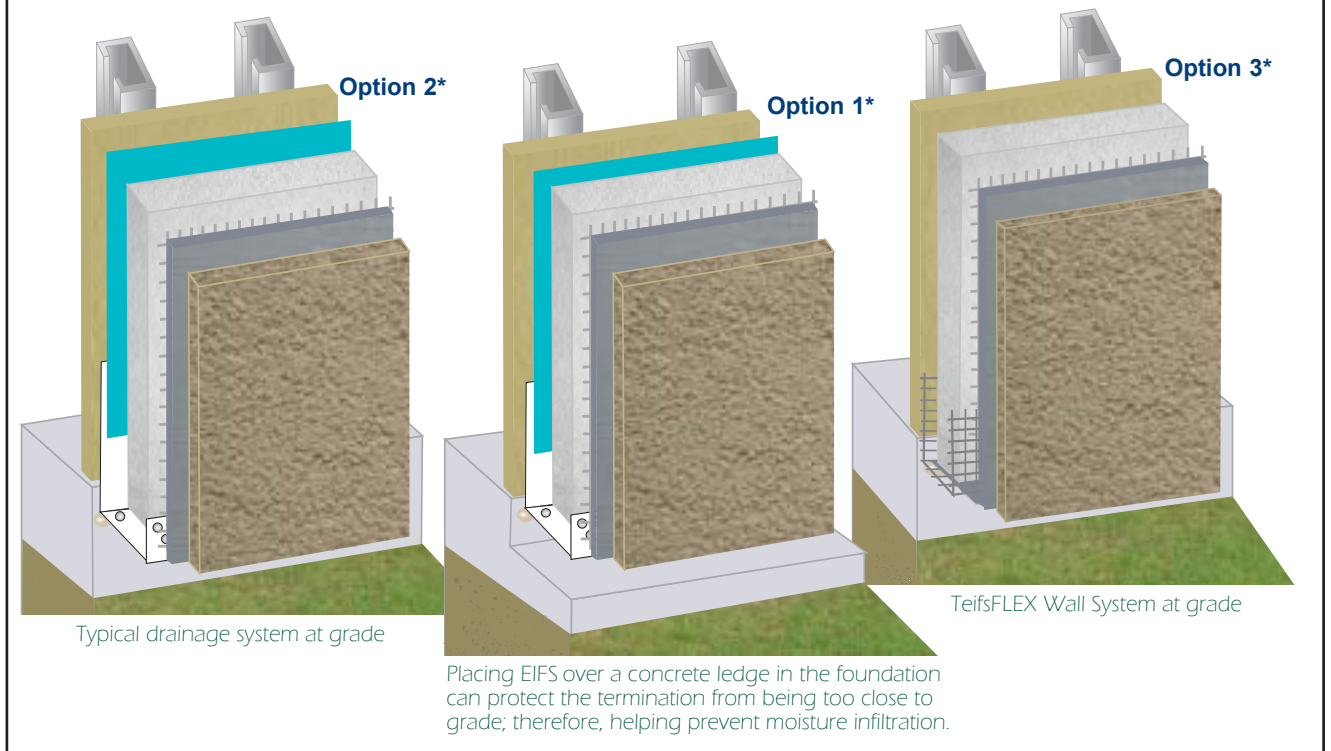

*\*All three options can be used for EIFS and EIFS with drainage. Sealant shall be installed to prevent water from entering the wall assembly at the intersection of the foundation and EIFS termination.*

### PROTECTING THE EIF SYSTEM AT GRADE:

- Regional building codes will have requirements of as much as 8" that the system must be terminated above grade. Remember that the grade before and after construction will be different. Teifs recommends a minimum of 2".
  - Grade should be sloped away from the wall.
  - Direct sprinklers away from the wall.
  - Un-landscaped areas may splash onto the wall staining the finish coat.
  - Provide high impact resistance reinforcing mesh to ground floor areas of the wall that will be exposed to pedestrian traffic or other impact exposure.
- Alternative option: Extend the base coat onto the foundation



# TeifsWEATHERTIGHT VNT Wall System

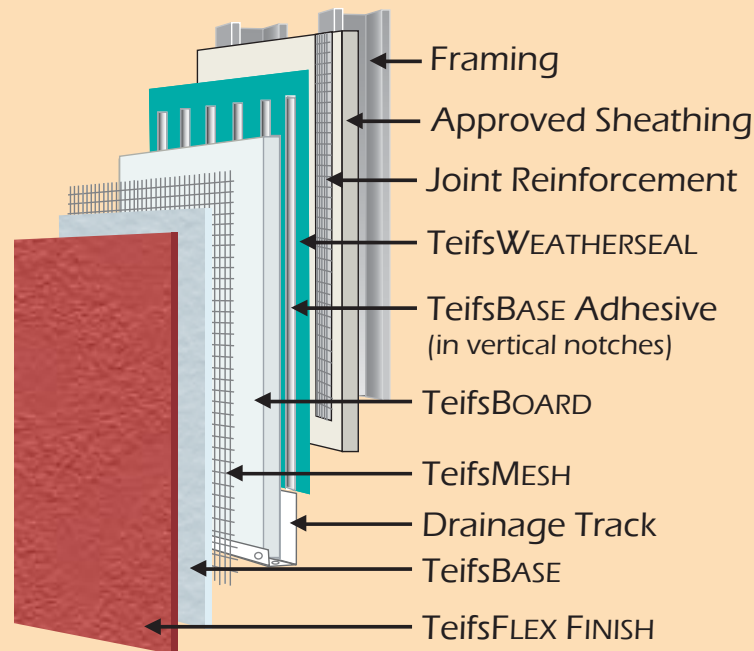

This Exterior Insulation and Finish System features multiple layers of protection against water penetration:

- ❖ *TeifsWEATHERSEAL, a special 100% acrylic air shield and waterproof protective coating*
- ❖ *Drainage created by installation of vertical notches of adhesives*
- ❖ *TeifsLAMINA (base coat, mesh, and finish), tested above and beyond industry standards*
- ❖ *Drainage Track*

**Look for more TeifsTEK TIPS Coming Soon!**



220 Burleson • San Antonio, Texas • 78202  
Phone (210) 472-2935 • Fax (210) 472-2946 • 1-800-358-4785  
[www.teifs.com](http://www.teifs.com) • [teifs@teifs.com](mailto:teifs@teifs.com)