

Teifs TEK TIPS

November 2004

Category 1

Detailing Series

The issue:

AESTHETIC GROOVES/REVEALS

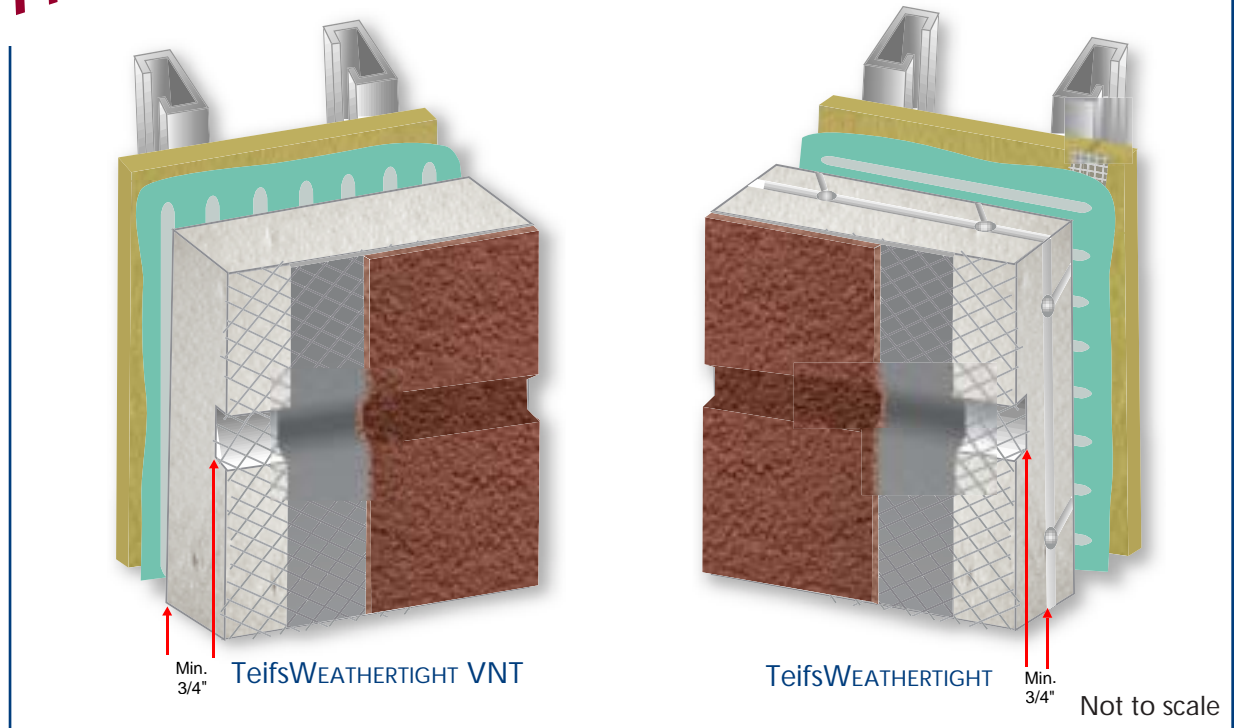

DESIGN NOTES

Aesthetic reveals may be useful on large wall sections to allow the installer a starting and stopping place when applying finish material.

Do not locate reveals/aesthetic grooves at high stress areas such as corners of windows, doors, etc.

Whether using flat or grooved insulation board, a minimum 3/4" of flat, uncut insulation board must be left at the base of the reveal. Thickness less than 3/4" can lead to cracking at the base of the reveal. Also, it is important to take into account that the insulation board may lose thickness after rasping. Slope the bottom of all horizontal reveals so that there will be no standing water.

INSTALLATION NOTES

The reinforcing mesh must be continuous through the reveal to a minimum of 2-1/2" of either side of the reveal. If using detail mesh in the reveal, then lapping the mesh over it, the overlap must be a minimum of 2-1/2" on each side of the reveal.

When using a tool to embed the mesh into the reveal, be careful not to cut the mesh. If the mesh is cut, a new piece of mesh *must* be installed over the cut to insure a 2-1/2" overlap exists.

The mesh must be fully embedded in the base coat.

Offset reveals/aesthetic grooves a minimum of 3 inches from insulation board joints.



Teifs WEATHERTIGHT Wall System

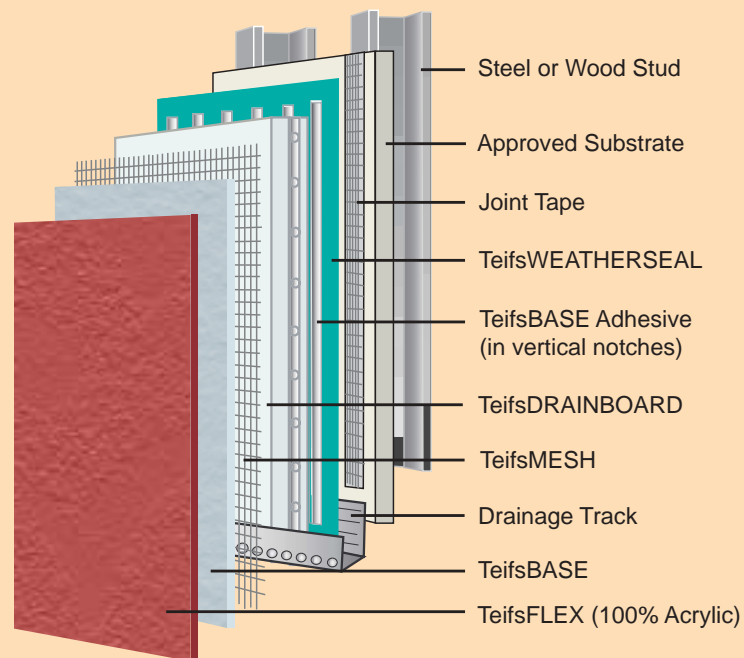

This Exterior Insulation and Finish System features multiple layers of protection against water penetration:

- ❖ *TeifsWEATHERSEAL, a special 100% acrylic air shield and waterproof protective coating*
- ❖ *TeifsDRAINBOARD, exclusively patented with vertical and horizontal drainage channels*
- ❖ *TeifsLAMINA (base coat, mesh, and finish), tested above and beyond industry standards*
- ❖ *Drainage Track*

Look for more TeifsTEK TIPS Coming Soon!



220 Burseson • San Antonio, Texas • 78202
Phone (210) 472-2935 • Fax (210) 472-2946 • 1-800-358-4785
www.teifs.com • teifs@teifs.com