

Teifs TEK TIPS

September 2004

Category 3

Detailing Series

The issue:

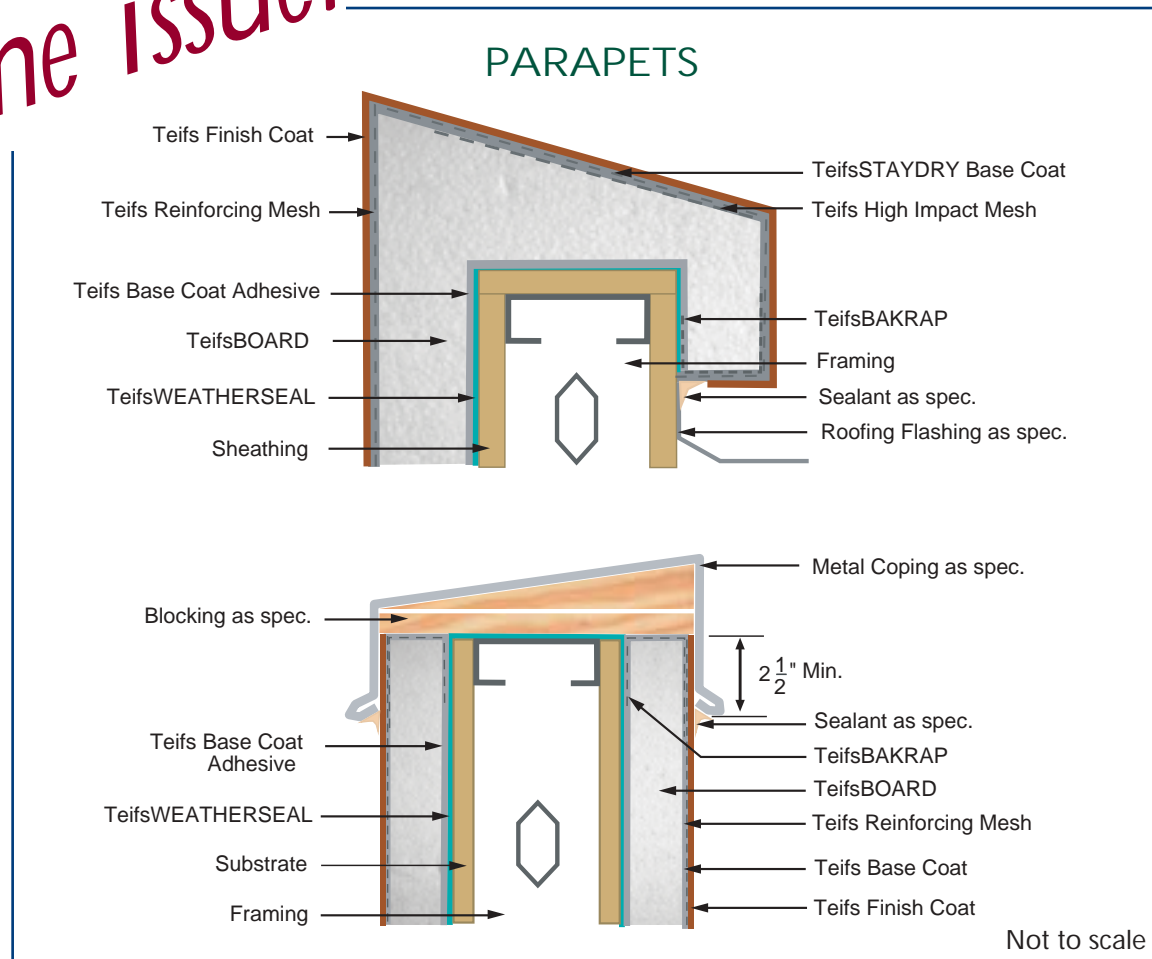

NOTES

EIFS is not recommended as a horizontal (ROOFING) material and Teifs always recommends that the top of parapets be covered with a metal parapet cap with the metal cap flashing extending over the front and back face of the parapet walls a minimum of 2-1/2".

If a metal parapet cap is not possible, EIFS can be used with the following stipulations:

- A layer of high impact 20 ounce mesh is installed under the standard mesh on the flat upward surfaces
- TeifsSTAYDRY Waterproof base coat is used as the base coat material
- The sheathing under the parapet is protected with a waterproofing material such as TeifsWEATHERSEAL



Teifs WEATHERTIGHT Wall System

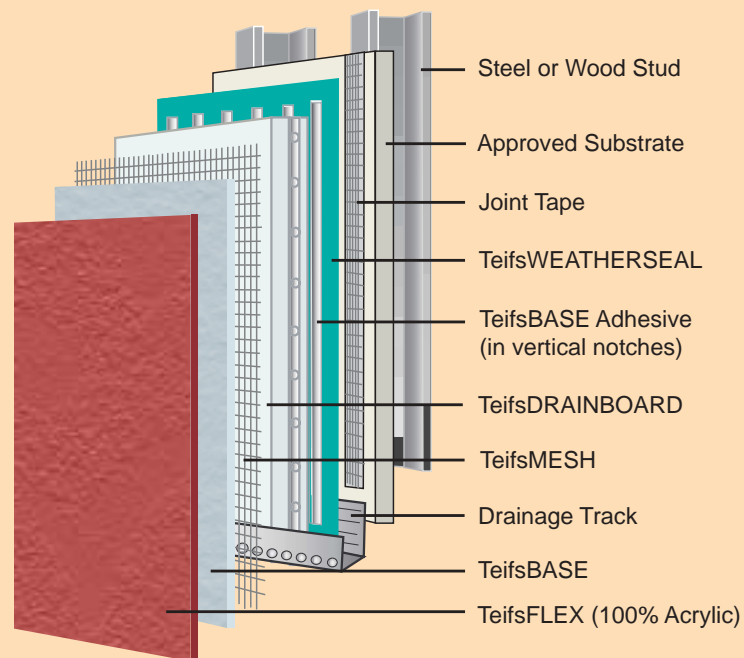

This Exterior Insulation and Finish System features multiple layers of protection against water penetration:

- ❖ *TeifsWEATHERSEAL, a special 100% acrylic air shield and waterproof protective coating*
- ❖ *TeifsDRAINBOARD, exclusively patented with vertical and horizontal drainage channels*
- ❖ *TeifsLAMINA (base coat, mesh, and finish), tested above and beyond industry standards*
- ❖ *Drainage Track*

Look for more TeifsTEK TIPS Coming Soon!



220 Burseson • San Antonio, Texas • 78202
Phone (210) 472-2935 • Fax (210) 472-2946 • 1-800-358-4785
www.teifs.com • teifs@teifs.com